

**ORDERING INFORMATION**

|  |  |
|--|--|
| <b>Stroke</b><br>025, 050 & 075mm  |  |
| <b>Actuator</b><br>N Pneumatic - NPT Ports<br>G Pneumatic - G Ports                              |  |
| <b>Ram Dowels</b><br>D06,D08,D10 (Dowels are Nominal)  |  |
| <b>Ram Holes</b><br>C09, C11 Clearance holes<br>M08, M10 Tapped Holes                            |  |
| <b>Switch</b><br>E Effector Weld Immune<br>B Balluff<br>T Turck<br>S Sick (Standard) Weld Immune |  |
| <b>Shield</b><br>0 None<br>S Safety Orange (Standard)<br>B Black                                 |  |

|  |  |
|--|--|
| <b>Switch Position</b><br>E S01 Ext Pos<br>R S01 Ret Pos   |  |
| <b>Handle Position</b><br>1 Position (Shown)<br>2 Position<br>3 Position<br>4 Position                   |  |
| <b>Ram Position</b><br>0 0 Degree (Shown)<br>9 90 Degree   |  |
| <b>Detent (See Note)</b><br>(See Sht 2 for 75mm stroke Dims)<br>0 None<br>D Detent                       |  |
| <b>Port Position</b><br>1 Port Position (Shown)<br>2 Port Position<br>3 Port Position<br>4 Port Position |  |

**NOTE:** Detent option is intended to hold ram in extended position due to loss of air pressure. Detent is not designed to hold GEO location. Tooling weight is not to exceed 12lbs [5kg] vertical. Available for 25-50mm strokes. Cylinder length will change for 75mm stroke. Body length and cylinder length will increase for 75mm Detent option. Please refer to sheet #2 for 75mm stroke dimension. Approx push/pull force force = 14Lbf to move

|     |         |      |    |
|-----|---------|------|----|
| SYM | CHANGES | DATE | BY |
|-----|---------|------|----|

**RAM HOLE ORDERING CHART**

| RAM STYLE | Dowels       | HOLES        | STANDARD |
|-----------|--------------|--------------|----------|
| D06 , C09 | 6.00mm THRU  | 9.0 THRU     | ** FCA   |
| D06 , M08 | 6.00mm THRU  | M8 TAP THRU  |          |
| D08 , C09 | 8.00mm THRU  | 9.0 THRU     | ** GM    |
| D08 , M08 | 8.00mm THRU  | M8 TAP THRU  |          |
| D08 , C11 | 8.00mm THRU  | 11.0 THRU    | ** FORD  |
| D08 , M10 | 8.00mm THRU  | M10 TAP THRU |          |
| D10 , C11 | 10.00mm THRU | 11.0 THRU    |          |
| D10 , M10 | 10.00mm THRU | M10 TAP THRU |          |

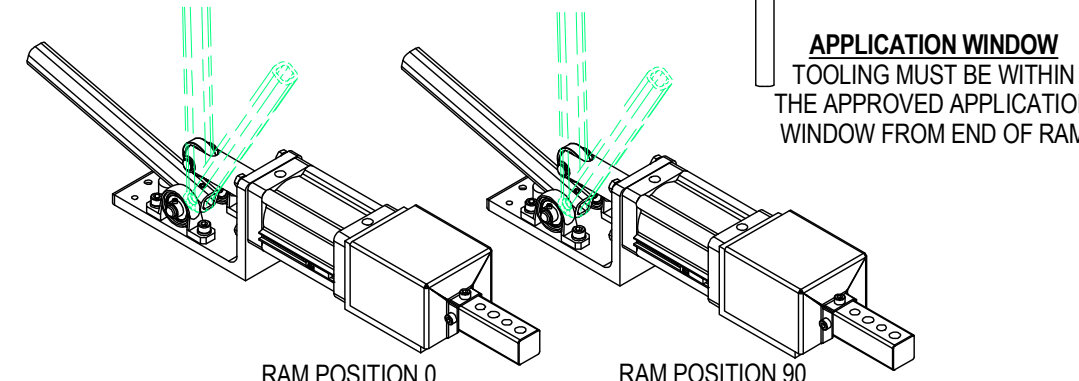
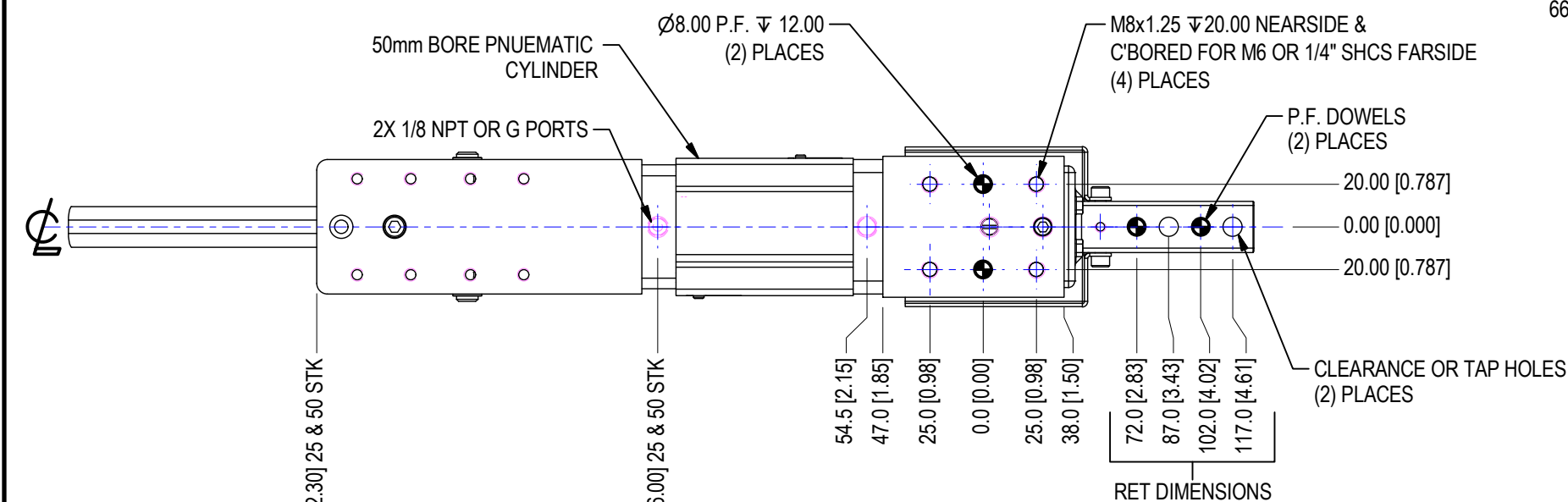
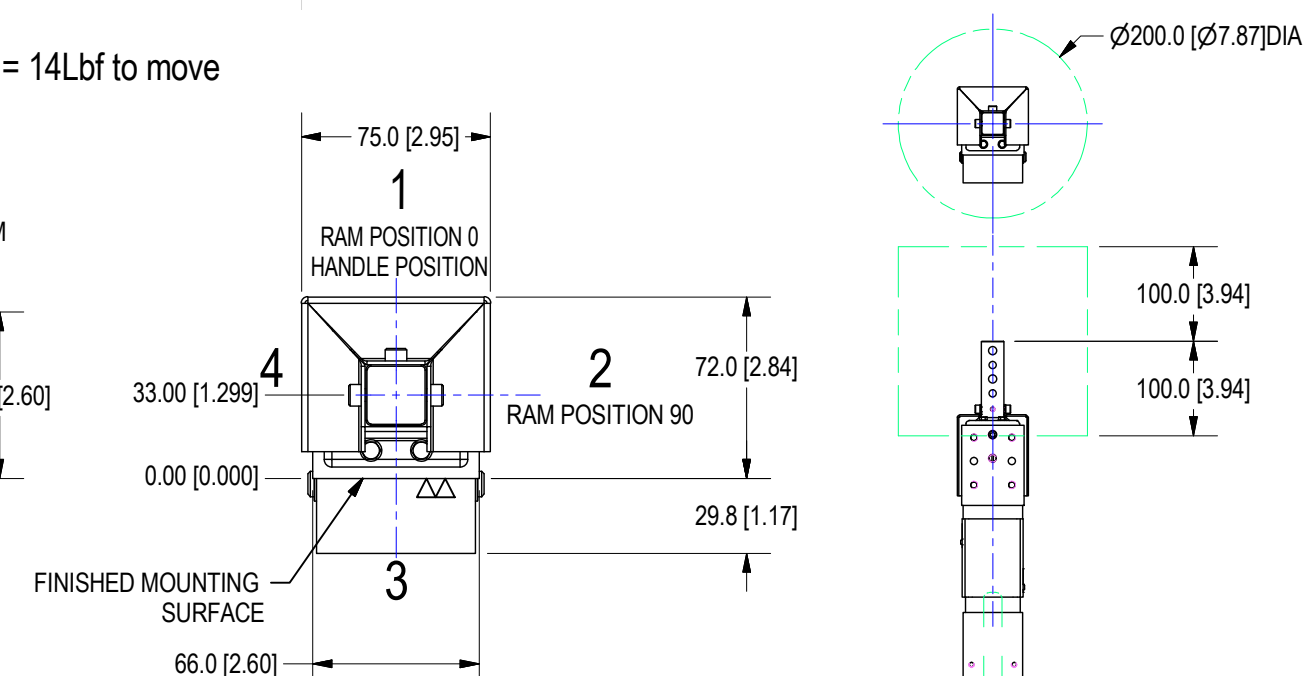
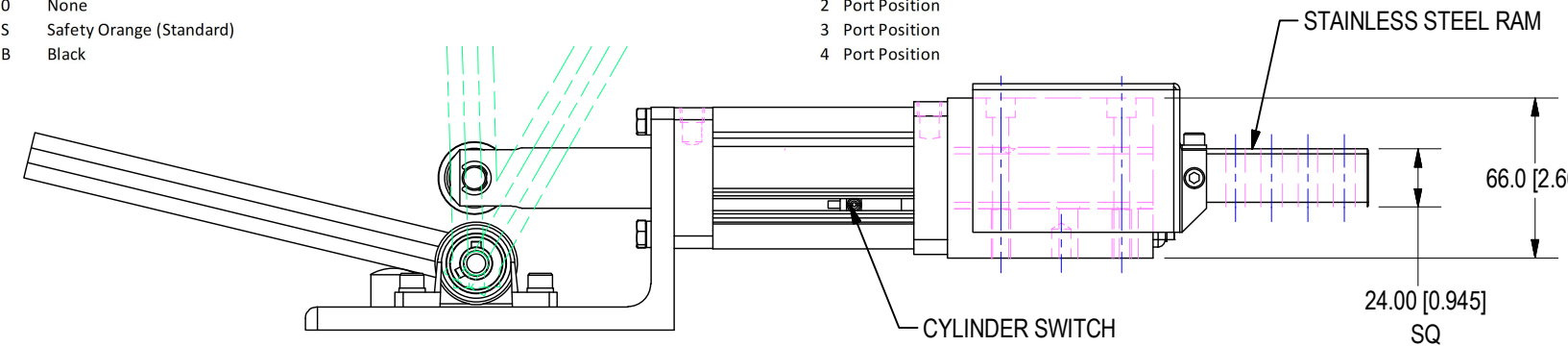

**OPERATING PRESSURE - MIN 60psi = 182lbf [82.5kgf] EXT FORCE - 169lbf [76.6kgf] RETRACT FORCE**  
**MAX 120psi = 362lbf [164.2kgf] EXT FORCE - 338.5lbf [153.5kgf] RETRACT FORCE**  
**LOAD RATING - MAX TOOLING WT=12lbs [5kg], MAX GEO CONTACT OFFSET IS 100mm. MAX SIDE LOAD IS 55lbs [25kg]**

**WEIGHTS =**  
 8.5lbs for 25mm & 50mm Strokes  
 9.0lbs for 75mm Stroke  
 10.1lbs for 75mm Stroke - Detent Option

|                                     |   |                       |  |
|-------------------------------------|---|-----------------------|--|
| <b>E &amp; E</b><br>CUSTOM PRODUCTS | <b>NOTICE:</b> THIS DRAWING IS PROPERTY OF E&E CUSTOM PRODUCTS INCLUDING THE PRINCIPLES OF THE DESIGN INVOLVED, AND IS SUBMITTED WITH AGREEMENT THAT IT IS NOT TO BE REPRODUCED, COPIED, OR LOANED, IN PART OR WHOLE, ACCEPTANCE OF THIS DRAWING WILL BE CONSTRUED AS AN AGREEMENT TO THE ABOVE |                       |  |
|                                     | <b>TITLE</b><br>24 SERIES MANUAL SHOT PIN   |                       |  |
| <b>PART NO.</b>                     |   |                       |  |
| <b>DRAWN BY:</b>                    | <b>CHK'D BY:</b>  | <b>APPR'D BY:</b>     |  |
| <b>DATE:</b>                        | <b>DATE:</b>  | <b>DATE:</b>          |  |
| <b>SCALE:</b> 1/3                   | <b>DWG. NO.</b>   | <b>MSP24-Template</b> |  |
| <b>SHT</b> 1 <b>OF</b> 2            |   |                       |  |

|     |         |      |    |
|-----|---------|------|----|
| SYM | CHANGES | DATE | BY |
|-----|---------|------|----|

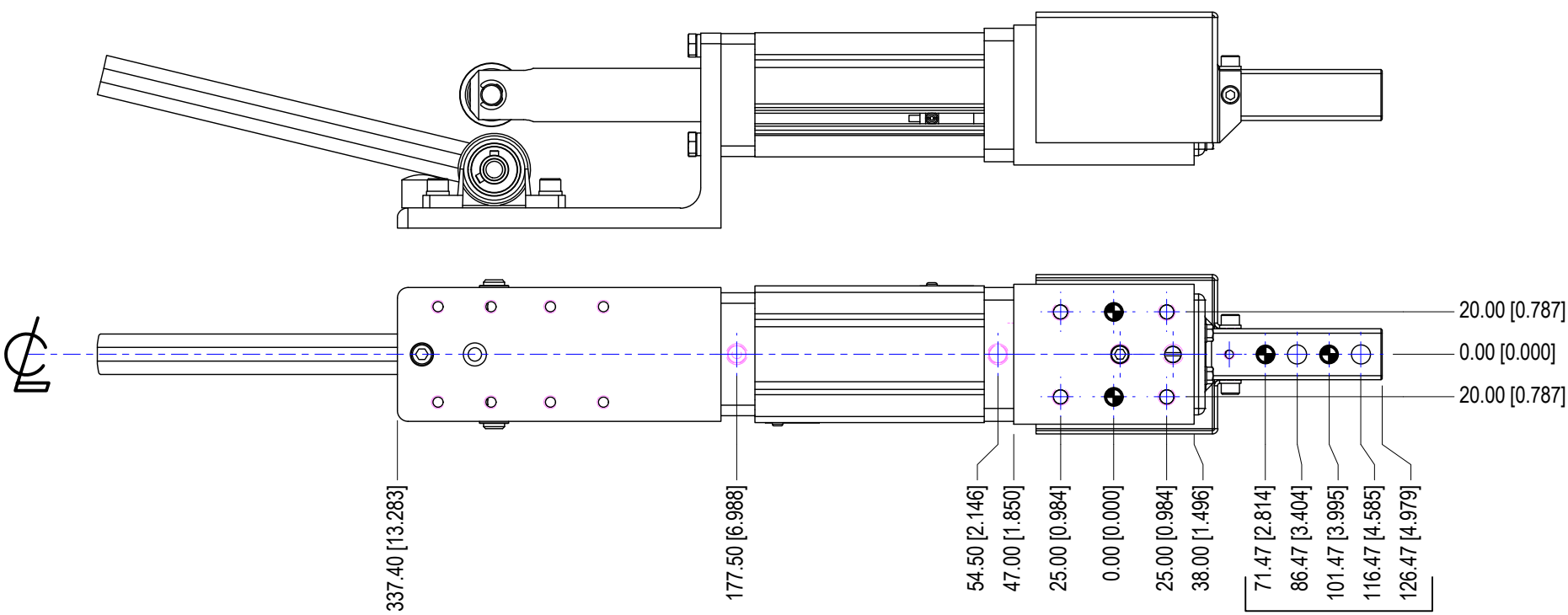

DIMENSIONS FOR 75mm STROKE OPTION

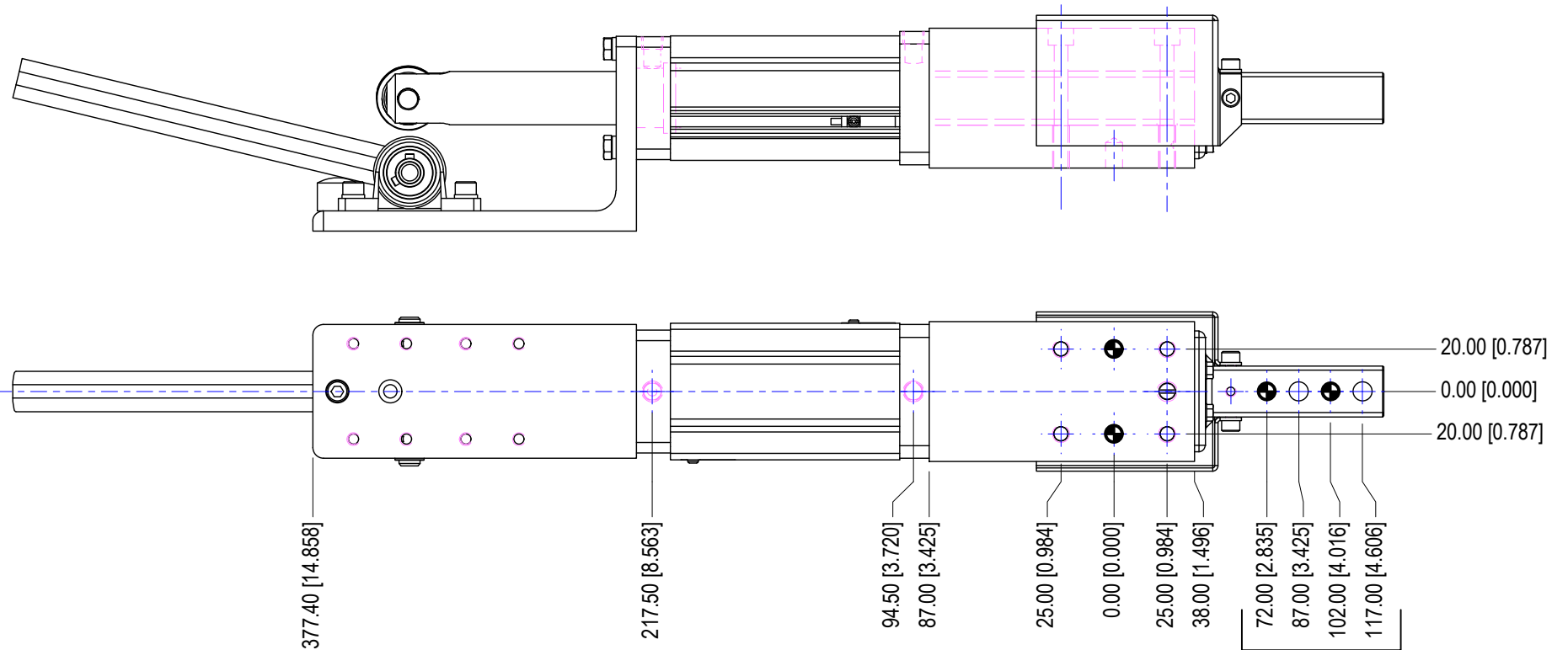
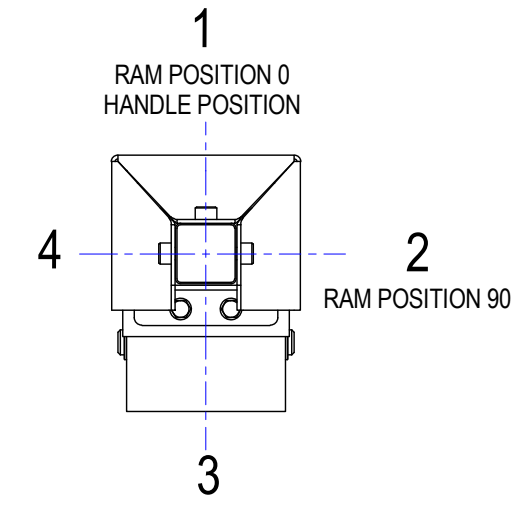
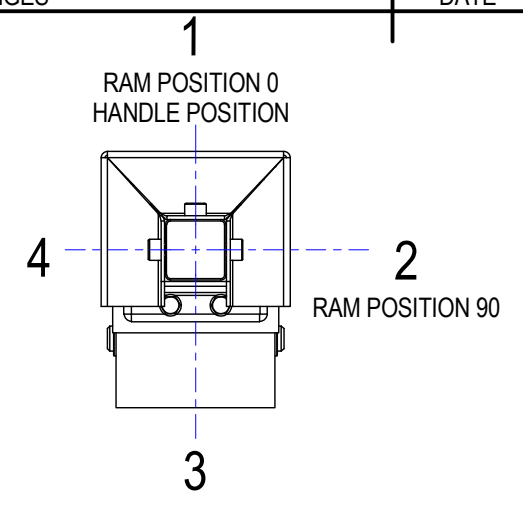

DIMENSIONS FOR 75mm STROKE DETENT OPTION

|   |   |   |  |
|---|---|---|--|
|   | <small>NOTICE: THIS DRAWING IS PROPERTY OF E&amp;E CUSTOM PRODUCTS INCLUDING THE PRINCIPLES OF THE DESIGN INVOLVED, AND IS SUBMITTED WITH AGREEMENT THAT IT IS NOT TO BE REPRODUCED, COPIED, OR LOANED, IN PART OR WHOLE, ACCEPTANCE OF THIS DRAWING WILL BE CONSTRUED AS AN AGREEMENT TO THE ABOVE</small> |   |  |
|   | <b>TITLE</b> 24 SERIES MANUAL SHOT PIN  |   |  |
| <b>PART NO.</b>   |   |   |  |
| <b>DRAWN BY:</b><br><small>7200 MILLER DR.<br/>         WARREN, MI 48092<br/>         EE-CP.COM</small> | <b>CHK'D BY:</b><br><small>DATE:</small>  | <b>APPR'D BY:</b><br><small>DATE:</small> |  |
| <small>SCALE:</small> 1/3<br><small>SHT</small> 2 <small>OF</small> 2                                   | <small>DWG. NO.</small> MSP24-Template  |   |  |